

Installation Tips

BEFORE YOU BEGIN

1. Read these instructions and check to be sure all parts and tools are accounted for.
2. Please retain these installation instructions for future reference and parts ordering information.

IMPORTANT

1. Please read the installation instructions carefully before you start.
2. If the vehicle is clean and free of other debris, it will be easy to install.
3. For your safety and to ensure a satisfactory installation, please complete all the installation steps in the order shown below.

PRODUCT INFORMATION:

- | | |
|-------------------------------|-----|
| 1. LH Front Fender Flare | x1 |
| 2. RH Front Fender Flare | x1 |
| 3. LH Upper Rear Fender Flare | x1 |
| 4. RH Upper Rear Fender Flare | x1 |
| 5. LH Lower Rear Fender Flare | x1 |
| 6. RH Lower Rear Fender Flare | x1 |
| 7. 1" Screw | x28 |
| 8. 3/4" Screw | x8 |
| 9. Washer | x72 |
| 10. Lock Nut | x36 |
| 11. Spacer | x12 |

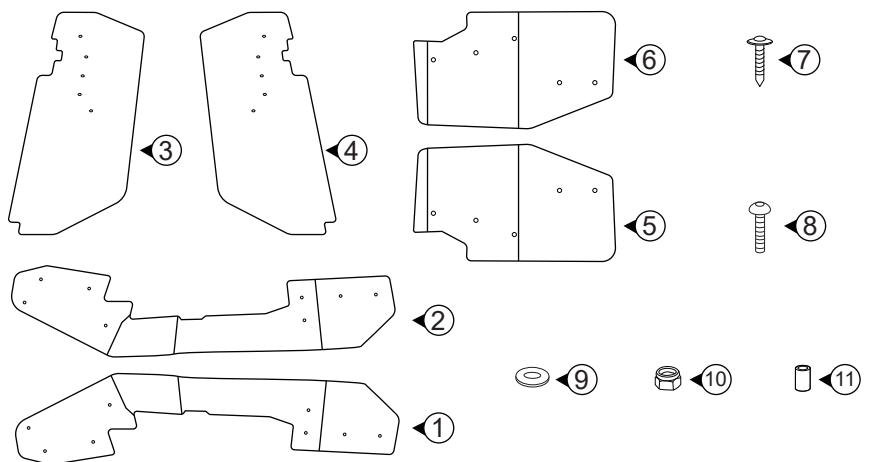

INSTALLATION TIPS:

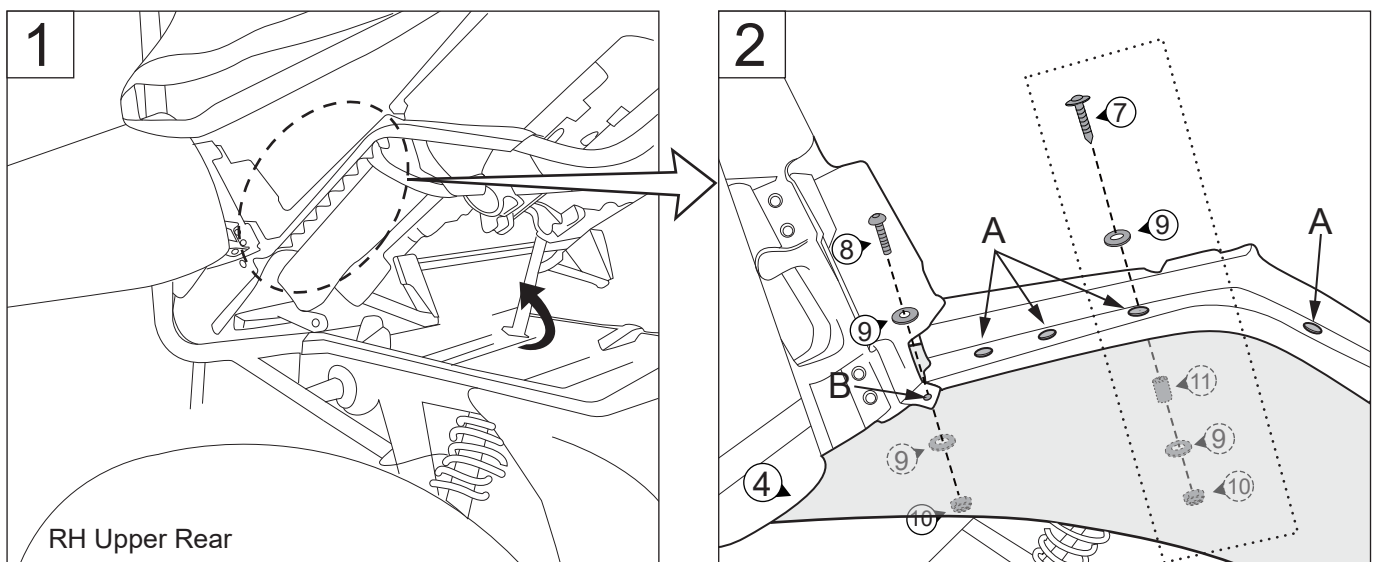

1. Have the dump bed in the upright position and open the rear door.
2. Place RH rear upper fender flare [4] under the factory fender, mark and drill four mounting holes A. On each hole A, use one 1" screw [7], two washers [9], one spacer [11] and one nut [10] to secure the fender flare. For hole B, use one 3/4" screw [8], two washers [9] and one nut [10] to fix.

3. Line up RH lower rear fender flare [6] to the factory fender, mark and drill five holes. On each hole C, install one 3/4" screw [8], two washers [9] and one nut [10]. On each hole D, install one 1" screw [7], two washers [9], one spacer [11] and one nut [10].

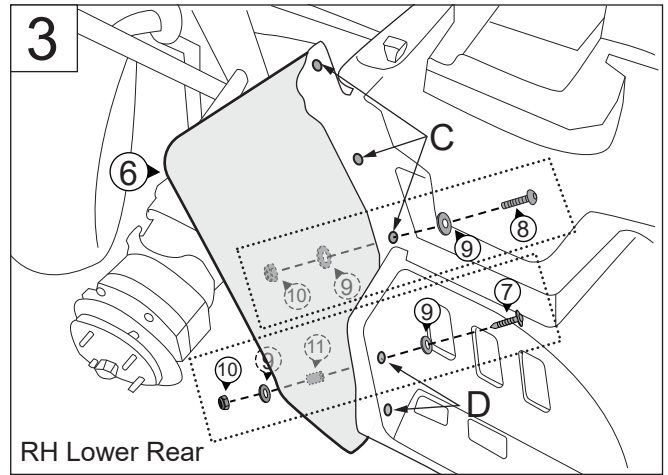

4. Remove two plastic rivets from front factory fender.

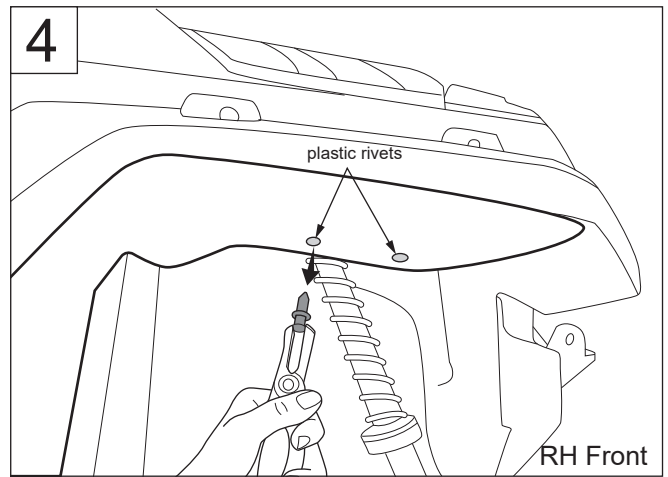

5. Place the RH front fender flare [2] against the inside of factory fender, align at the holes left from the plastic rivets, mark and drill on other two mounting holes of the fender flare. Install one 1" screw [7], two washers [9], and one nut [10] on each hole to secure.

Note: Pull down the factory fender and slide your arm in to reach the backside so that you can add and tighten hardware.

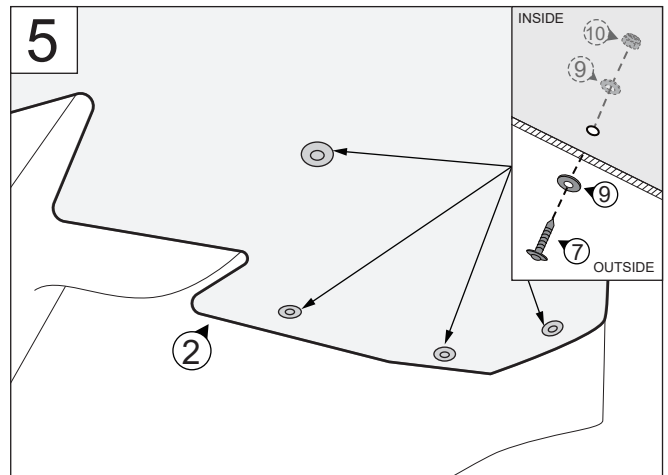

6. Push up the lower part of the fender flare [2] to reduce any gab in the corner of the factory fender. Mark and drill four holes. For each hole, install one 1" screw [7], two washers [9], and one nut [10] to secure.

7. Repeat step 2-6 for the other side installation.

